



Stage Lighting Rules 2016

Royal South Street Commbank Calisthenics Competitions

**** Please note this information has been updated from previous years:**

The following Lighting Rules apply to all competitors in the Calisthenics sections that permit the use of Fancy and Special lighting,

- All Clubs **MUST** complete a **LIGHTING CUE SHEET** per item, Lighting Cue sheets are not required for sections which use Standard lighting. A separate official Lighting Cue sheet must be completed for each item in each section.
- Official Lighting Cue sheets must be completed and returned to the Royal South Street Society office by **Friday, 9th September**. All forms **MUST** be typed and sent via post **or** emailed to compsforms@royalsouthstreet.com.au (*Calisthenic curtain forms must be sent at the same time as lighting forms*).
- Non-return of the Lighting Cue sheet will mean no special lighting and the performance restricted to standard lighting only. On-the-spot demands for lighting not listed on the Lighting Cue sheet will not be possible.
- No extra lighting or special effects equipment may be used. Props must be made available to the Her Majesty's Theatre Duty Technician for approval prior to the start of the section.
- **Twelve (12) cues only (not including preset and B/O at end of item)** per item are allowed. Up to Five (5) allowable lighting effects may be included in one cue (see Allowable Lighting List and Sample Cue sheets attached), provided it is possible to operate the Lighting Cue with these requested effects.

PLOTTING SESSIONS:

2016: Once again we require Expressions of Interest in Plotting Session bookings. These are due **Friday, 9th September** (to be submitted at the same time as your Risk Assessment). This is to ensure sufficient Theatre Techs are available to work with competitors. All Plotting Sessions must be booked through the Royal South Street Society office. **NB:** *If we are not advised of your intention to book a Plotting Session you may miss out.*

No Plotting Session will commence or continue after 2.00am.

Only 1 Coach and 2 ADULT assistants (to be named) (one to run DLP, another to walk on stage so coach can see light on faces, which technicians highly recommend) are allowed at the Plotting Session, including Graceful & Calisthenic Solo plotting sessions. **Please note: If coaches do not bring someone to walk on stage to see faces during plotting, technicians are NOT responsible for the outcome.*

- Plotting Sessions will be available at the close of Evening Dance Troupes competitions from **13 September to 1 October**. Please check with the RSSS Office for availability. Also throughout the Calisthenic sections half hour after the close of the competition daily.
- Coaches must stay in greenroom until asked to come onto stage by technicians.
- For complicated lighting requirements it is highly recommended by Her Majesty's technicians to book a Plotting Session. Otherwise you will risk the chance of not getting what you want as live operation is limited. ***NB: Division 5, 6 & 7 sections over all age groups in Calisthenics must be called live, plotting is NOT available, but you can use DLP. Note: see projection notes***

- Clubs will be charged **\$65** for a Plotting Session of 20 minutes.
- Each Club may book a 20 minute maximum Plotting Session per division or age group (Plotting Sessions are booked in 30 minute blocks to allow 10 minute's time to save plotted data at the end of the session).
- Technicians recommend on having your items pre-planned as this will ensure you have enough time to complete your cues in the given time frame.
- Please bring your lighting sheets with you to plotting sessions, the technicians **DO NOT** pre-plot, and **DO NOT** have your lighting sheets.
- Within a 20 minute Plotting Session it is estimated that only 2-3 items will be plotted.
- Calisthenic **Intermediate Championship, Championship Reserve** and **Senior Championship** will be allocated ONE (1) HOUR in total and the price is **\$125**.
- Plotting Session times will be allocated at the discretion of the Royal South Street Society.
- During the Calisthenic Sections, Plotting Sessions will only be held at night after competitions close or in times when no competition is scheduled.

Graceful & Calisthenic Solos - Graceful & Calisthenic Solos **CAN** be plotted. **No Graceful girls or Calisthenic Solo competitors are allowed on stage during ANY plotting session.**

- **Thursday, 13th October 9am to Midday and Friday 14th October 10am to 5.45pm are reserved for Graceful / Calisthenic Solo Plotting Sessions.** Each soloist is allowed 15 minutes at the cost of \$35 which is pre-paid as you confirm your entry via the website. The 15 minutes will consist of 10 minutes for plotting and 5 minutes to save the data.
- **Due to this day being used for Graceful & Calisthenic Solo plotting, teams wishing to plot for Senior Champ and Champ Reserve will need to ensure they book times well in advance to plot.**

LIGHTING INFORMATION 2016

*****Please note there are NO Side Lights or Backlights anymore.**

- **Stage Washes:** Red, Green, Blue, Amber, Yellow, Pink, Purple, Aqua, Light Green, Light Blue and White (open white/general stage light) **No variations allowed.** Front of house/face light is included in washes unless stated otherwise.
- **Cyc Colours:** Same as Stage Washes. **No variations allowed.** Can be used either in conjunction with or independent to Stage wash.
- **Decal** (dapple effect over the stage): with or without Stage wash.
- There is a **Downstage White Strip of Light** (Kick light at the stage edge).
- Coloured lights **DO NOT** show up on black back curtain.
- It is **NOT** possible to split colour on cyc.
- **Dress fill's** (white light focused onto cyc from front of house) are included in the Front of House/face light and not a separate lighting effect unless plotted.

- Data projector does not work with full blinders, full front of house lights or full cyc lights but will work if used with a lower % of strength. ***Please note faces will not be as bright if using projection.**
- Prop lighting is **NOT** controlled by the technician/lighting operator – the coach/team must turn item on and off themselves via 240v power points backstage.

FIXED SPOTLIGHTS

Stage Spots: ie. White spotlights fixed above the stage that throw Cones of light to distinct circles onto the stage. There are 9 spots in 3 rows of 3. See figure below. *Each change of combination of spotlights used is considered as part of one Lighting Cue.*

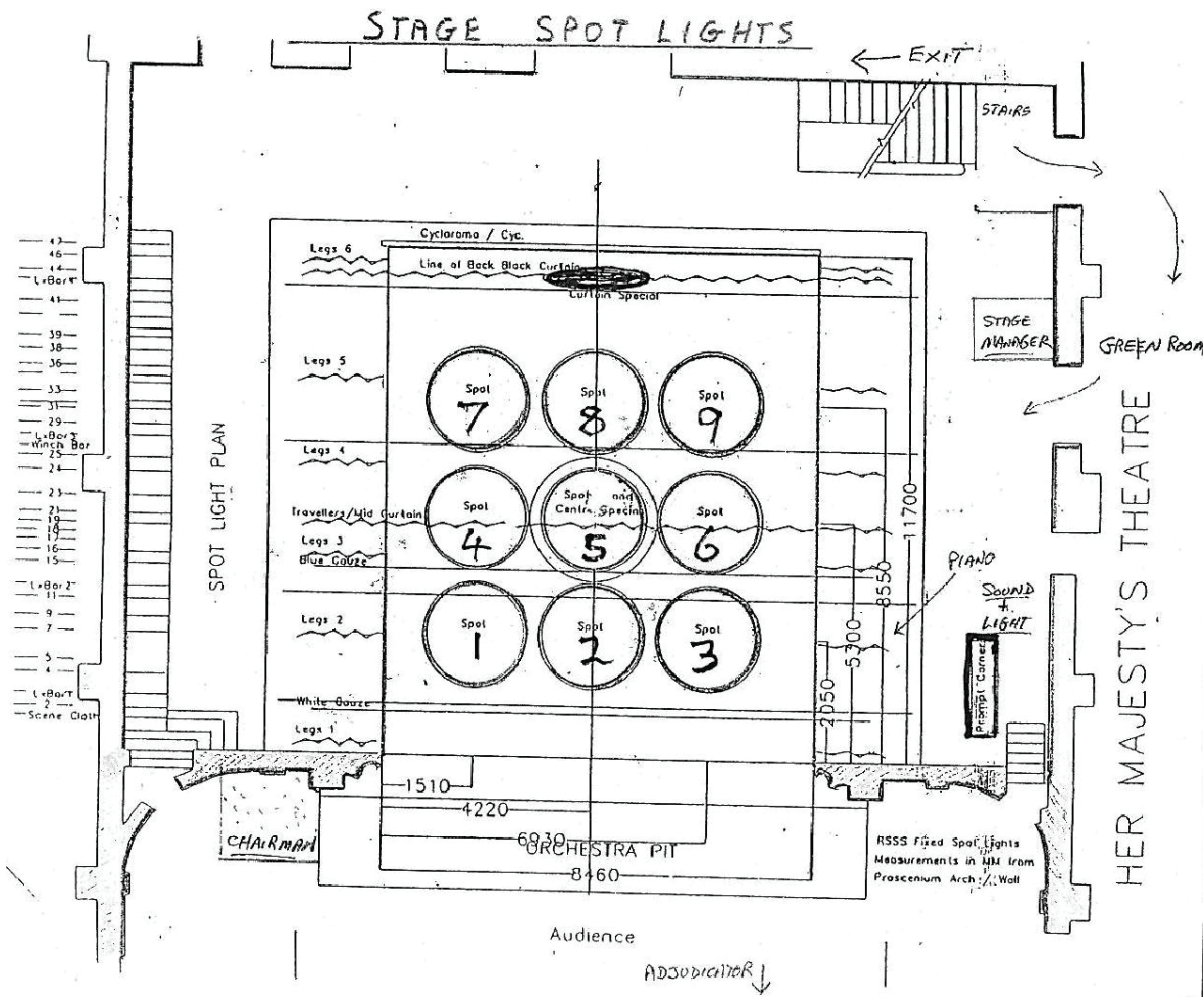

Centre special: A larger spot at centre stage, (over spot No. 5) suitable for groups. *Considered as part of one Lighting Cue.*

Curtain special: Illuminates the centre opening of the back black curtain. Used for entrances through the back black curtain. In fancy and special lighting items coloured light may be used on the cyclorama. *Considered as part of one Lighting Cue.*

SPECIAL EFFECTS

UV (Ultraviolet light): Requires a blackout to work.

Mirror ball: Mirror ball has 2 options, spinning or stopped. **Can NOT alter speed.**

Chase: (rapid changing of colours of Stage or Cyclorama wash). Also spot chases available. *Considered as part of one cue.*

Blinders: (bright lights): set in front corners of stage. These can be used separately or together and are on OP and Prompt side.

FOLLOW SPOT

One follow spot only is available for use by Competitors who provide suitably qualified operators approved by the Her Majesty's Theatre Duty Technician.

Your Operator **MUST** see Her Majesty's Duty Technician in a meal break on the day of your item for training/run through. **If you don't see the Duty Technician, you CANNOT use it.**

CURTAINS

Silver Curtain: A silver curtain is available for use. This curtain is situated on the line closest to the cyc and will not be moved to any other position. Please indicate on your Curtain sheet if you wish to use this curtain.

Srim Curtain: This is not available in 2016 for Calisthenic Clubs to use.

SMOKE MACHINE

For sections in which use of a Smoke Machine is allowed, one may be hired from the Royal South Street Society at a cost of \$15 per competition item. Other fluid based effects may **NOT** be used. eg. dry ice, bubble machines, personal smoke machines