



Stage Lighting Rules 2017

Royal South Street Society Energetiks Dance Competitions

The following Lighting Rules apply to all competitors in the Dance that permit the use of fancy and special lighting, subject to the specific rules for each section.

- All competitors in the relevant Dance **MUST** complete a **LIGHTING CUE FORM** (see below). Lighting Cue forms are not required for sections which use Standard lighting.
- Official Lighting Cue forms must be completed and returned to the Royal South Street Society office **by Friday August 4th, following a plotted session or at least one week prior to the section**. All forms **MUST** be typed and can be emailed to: compforms@royalsouthstreet.com.au or posted to PO Box 33, Ballarat 3353
- Non-return of the Lighting Cue Form will mean no special lighting and the performance restricted to standard lighting only. On-the-spot demands for lighting not listed on the Lighting Cue Form will not be possible.
- No extra lighting or special effects equipment may be used. Props must be made available to the Her Majesty's Theatre Duty Technician for approval prior to the start of the section.
- **Twelve (12) cues only (not including preset and B/O at end of item)** per item are allowed. Up to Five (5) allowable lighting effects may be included in one cue (see Allowable Lighting List and Sample Cue sheets attached), provided it is possible to operate the Lighting Cue with these requested effects.
- A separate official Lighting Cue Form must be completed for each item in each section.

PLOTTING SESSIONS

Expressions of Interest in Plotting Session bookings. These forms are due in by Friday August 5th. This is to ensure sufficient Theatre Techs are available to work with competitors. All Plotting Sessions must be booked through the Royal South Street Society office. *NB: If we are not advised of your intention to book a Plotting Session you may miss out.*

Dance Schools must submit **Light Plotting Booking Forms** no later than **Friday August 5th, 2016**.

No Plotting Session will commence or continue after 2.00am.

Only 1 Coach and 2 ADULT assistants (one to run DLP, another to walk on stage so coach can see light on faces, which technicians highly recommend) are allowed at the Plotting Session, including Graceful plotting sessions. **Please note: If coaches do not bring someone to walk on stage to see faces during plotting, technicians are NOT responsible for the outcome.*

- A full day of Plotting Sessions will be made available on **Monday September 12, 2016**, for any dance schools or clubs that want to travel to Ballarat for an advance Plotting Session. Alternatively, Plotting Sessions will be available at the close of Evening Dance Troupes competitions from **22 September to 3 October**. Please check with the RSSS Office for availability.

- Coaches must stay in greenroom until asked to come onto stage by technicians.
- For complicated lighting requirements it is highly recommended by Her Majesty's technicians to book a Plotting Session. Otherwise you will risk the chance of not getting what you want as live operation is limited. *Note: see projection notes*
- Dance Schools will be charged **\$65** for a Plotting Session of 20 minutes.
- Each Dance School may book a 20 minute maximum Plotting Session per division or age group (Plotting Sessions are booked in 30 minute blocks to allow 10 minute's time to save plotted data at the end of the session).
- Technicians recommend on having your items pre-planned as this will ensure you have enough time to complete your cues in the given time frame.
- Please bring your lighting sheets with you to plotting sessions, the technicians **DO NOT** pre-plot, and **DO NOT** have your sheets.
- Within a 20 minute Plotting Session it is estimated that only 2-3 items will be plotted.
- Plotting Session times will be allocated at the discretion of the Royal South Street Society.
- During the Dance and Calisthenic Sections, Plotting Sessions will only be held at night after competitions close or in times when no competition is scheduled.

LIGHTING INFORMATION 2016

*****Please note there are NO Side Lights or Backlights anymore.**

- **Stage Washes:** Red, Green, Blue, Amber, Yellow, Pink, Purple, Aqua, Light Green, Light Blue and White (open white/general stage light) ***No variations allowed.*** Front of house/face light is included in washes unless stated otherwise.
- **Cyc Colours:** Same as Stage Washes. ***No variations allowed.*** Can be used either in conjunction with or independent to Stage wash.
- **Decal** (dapple effect over the stage): with or without Stage wash.
- There is a **Downstage White Strip of Light** (Kick light at the stage edge).
- Coloured lights **DO NOT** show up on black back curtain.
- It is **NOT** possible to split colour on cyc.
- **Dress fill's** (white light focused onto cyc from front of house) are included in the Front of House/face light and not a separate lighting effect unless plotted.
- Data projector does not work with full blinders, full front of house lights or full cyc lights but will work if used with a lower % of strength. ***Please note faces will not be as bright if using projection.**
- Prop lighting is **NOT** controlled by the technician/lighting operator – the coach/team must turn item on and off themselves via 240v power points backstage.

FIXED SPOTLIGHTS

Stage Spots: ie. white spotlights fixed above the stage, that throw Cones of light to distinct circles onto the stage. There are 9 spots in 3 rows of 3. See figure below. *Each change of combination of spotlights used is considered as part of one Lighting Cue.*

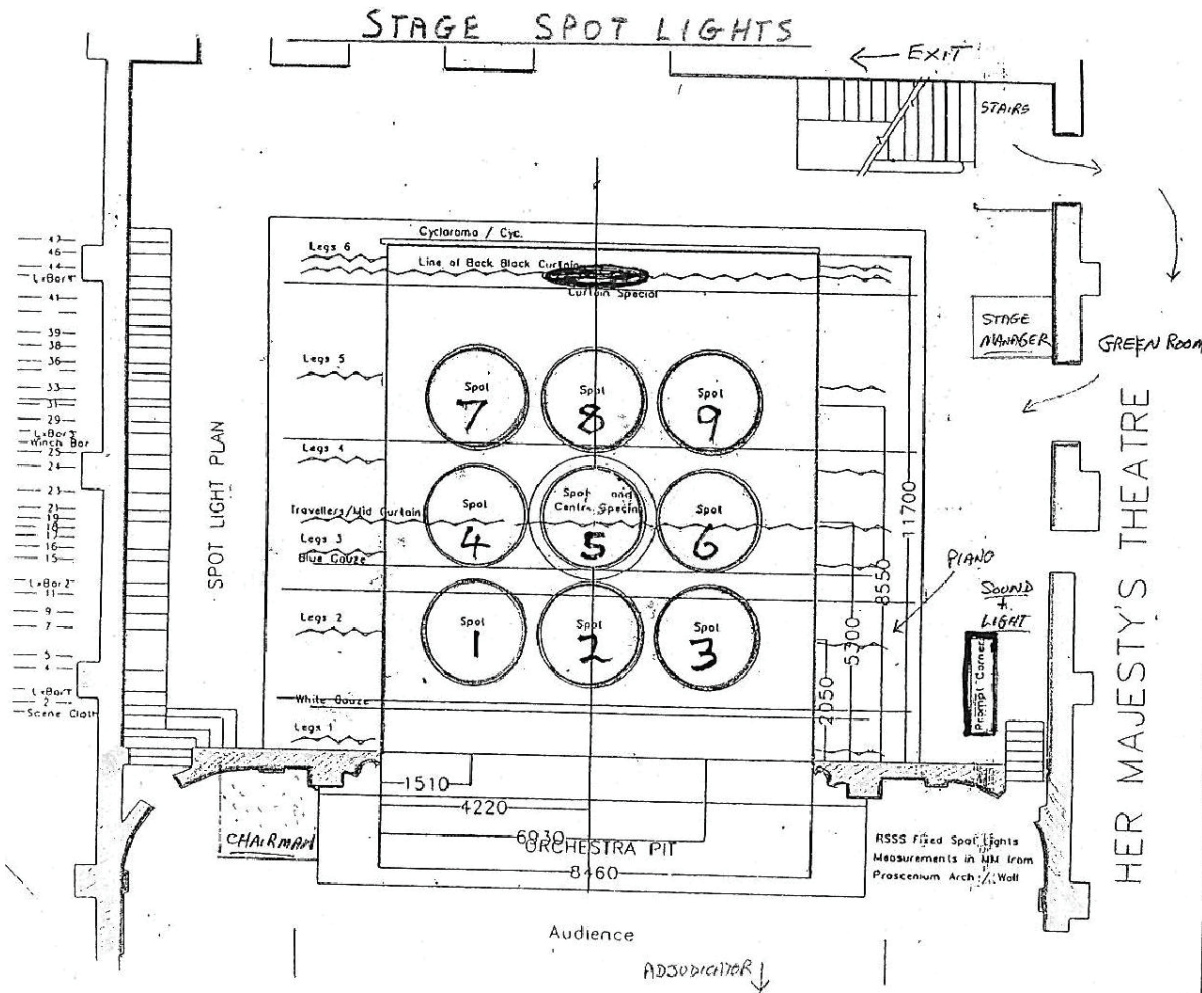

Centre special: A larger spot at centre stage, (over spot No. 5) suitable for groups. Considered as part of one Lighting Cue.

Curtain special: Illuminates the centre opening of the back black curtain. Used for entrances through the back black curtain. In fancy and special lighting items coloured light may be used on the cyclorama. Considered as part of one Lighting Cue.

SPECIAL EFFECTS

UV (Ultraviolet light): Requires a blackout to work.

Mirror ball: Mirror ball has 2 options, spinning or stopped. Can NOT alter speed.

Chase: (rapid changing of colours of Stage or Cyclorama wash). Also spot chases available. Considered as part of one cue.

Blinders: (bright lights): set in front corners of stage. These can be used separately or together and are on OP and Prompt side.

FOLLOW SPOT

One follow spot only is available for use by Competitors who provide suitably qualified operators approved by the Her Majesty's Theatre Duty Technician.

Your Operator **MUST** see Her Majesty's Duty Technician in a meal break on the day of your item for training/run through. **If you don't see the Duty Technician, you CANNOT use it.**

CURTAINS

Silver Curtain: A silver curtain is available for use. This curtain is situated on the line closest to the cyc and will not be moved to any other position. Please indicate on your Curtain sheet if you wish to use this curtain.

Scrim Curtain: (DANCE ONLY) in fixed position (Black, on line 10). Needs prior arrangement.

Considered as one cue. **If a scrim curtain is to be used the item must have a Plotting Session.*

SMOKE MACHINE

For sections in which use of a Smoke Machine is allowed, one may be hired from the Royal South Street Society at a cost of \$15 per competition item. Other fluid based effects may **NOT** be used. E.g. dry ice, bubble machines, personal smoke machines